

Hydraulic clamps type HSE and HSA

Hydraulic clamping cylinder generate a pressure-controlled clamping force at the piston. Without pressure the clamping pistons return to their initial position. The clamping cylinder type HSE is a screw-in cylinder. The type HSA is a screw-on cylinder. Very high forces can be transmitted in a very small space in fixtures. The clamping cylinder type HSE and HSA is used in machine tools, machining centres and chucks for clamping, fasten, lock or fix workpieces, tools or machine structures.

Features and benefits:

- Compact design
- Operating pressure up to 500 bar

Intended applications:

- Clamping systems
- Securing systems
- Machine tools



Nomenclature:	Hydraulic clamps
Design:	Screw-in version Manifold mounting
p_{max}*	500 bar
F_{max}*	60000 N

Design and order coding example

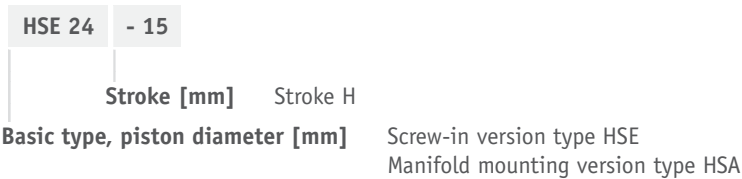

Function

HSE, HSA

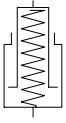

General parameters and dimensions

HSE ..

Hydraulic screw-in clamps

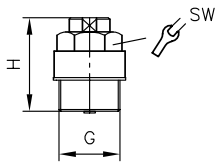

HSA ..

Manifold mounting hydraulic clamps

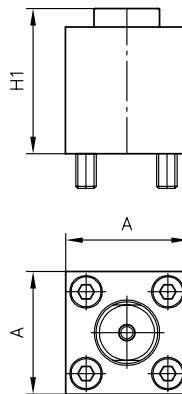

	Q _{max} [lpm]	Stroke [mm]	F _{max} [N]	Ports	Dimensions [mm]				m [kg]
					H	H1	SW = a/f	A	
			with 500 bar						
HSE 12	500	2 ... 8	5500	M 20 x 1.5	20.5 ... 32.5	-	SW 24	-	0.05 ... 0.08
HSE 16		3 ... 12	10000	M 24 x 1.5	26.5 ... 41.5	-	SW 24	-	0.08 ... 0.12
HSE 20		4 ... 20	15000	M 30 x 1.5	28.5 ... 56	-	SW 30	-	0.14 ... 0.3
HSE 24		5 ... 20	23000	M 36 x 1.5	34 ... 65	-	SW 36	-	0.25 ... 0.5
HSA 32		20	40000	-	-	71	-	60	1.6
HSA 40		25	60000	-	-	85	-	70	2.5

Associated technical data sheets:

- Hydraulic clamps type HSE and HSA: D 4711